



# THE UNIVERSITY OF OKLAHOMA

# Main Campus Map

Parking



### NUMERICAL LISTINGS

- 1 Old Faculty Club
- 2 Boyd House
- 3 Whitehand Hall
- 5 Fred Jones Jr. Memorial Art Center
- 6 Carson Engineering Center
- 8 Sarkeys Energy Center
- 9 Rupe J. Jones Theater
- 10 Holmberg Hall
- 11 Jacobson Faculty Hall
- 12 Carpenter Hall
- 13 Felgar Hall
- 14 Craddock Hall
- 15 Stanley Catlett Music Center
- 18 Physical Sciences Center
- 19 Chemistry Building
- 19A Chemistry Bldg. Annex
- 20 Monnet Hall
- 21 Oklahoma Memorial Union
- 21A OMU Parking Center
- 22 Engineering Laboratory
- 23 Physical Plant Complex
- 27 Burton Hall
- 28 Sutton Hall
- 29 Science Hall
- 30 Carnegie Building
- 31 Nuclear Engineering Laboratory
- 38 Goddard Health Center
- 39 Jim Thorpe Multicultural Center
- 40 Evans Hall
- 41 Buchanan Hall
- 43 Telecom Maintenance
- 46 Ellison Hall
- 49 Bizzell Memorial Library
- 49A Bizzell Library 1958 Addition
- 49B Neustadt Wing
- 50 Adams Hall
- 51 Savoie Lottinville Hall
- 52 Field House
- 53 Rhyne Hall
- 56 Hester Hall
- 56A Robertson Hall
- 57 Nielsen Hall
- 58 Richards Hall
- 58A Richards Hall Addition
- 59 Armory
- 61 Gittinger Hall
- 62 George Lynn Cross Hall
- 63B Noble Microscopy Laboratory
- 66 Oklahoma Memorial Stadium
- 67 Kaufman Hall
- 68 Ellsworth Collings Hall
- 69 Gould Hall
- 70 Copeland Hall
- 71 Dale Hall Tower
- 72 Dale Hall Classroom Building
- 75 Gomer Jones Dormitory
- 77 Jefferson House Dormitory
- 78 Collums Commissary
- 79 Jacobs Field
- 80 Bud Wilkinson Dormitory
- 81 Mosier Indoor Athletic Facility
- 82 Cate Center
- 87 Honors House (Cate Center Dorm #5)
- 88 Henderson-Tolson Cultural Center
- 93 Observatory
- 94 Wilson Center Main Bldg.
- 99 Adams Center
- 100 Walker Tower
- 103 Huston Huffman Physical Fitness Center
- 107 Couch Center Cafeteria
- 108 Couch Center South
- 113 OCCE Cottages
- 121 OCCE Commons Restaurant
- 122 OCCE McCarter Hall of Advanced Studies
- 124 Cross Center
- 128 OCCE Forum Building
- 129 OCCE Administration Building
- 136 OCCE Sooner House
- 137 Murray Case Sells Swim Complex
- 200 Law Center
- 201 Kraettli Apartments
- 203 Women's Softball Facility
- 204 OU Foundation
- 205 Sam Noble Oklahoma Museum of Natural History
- 207 Our Children's World Learning Center
- 209 Building 4 (Continuing Education)
- 210 L. Dale Mitchell Baseball Park
- 211 Sam Viersen Gymnastics Center
- 213 Bldg. 6, South Campus
- 215 Department of Public Safety
- 226 Fears Structural Engineering Lab
- 228 Oklahoma Biological Survey
- 236 Ceramic Kiln Facility
- 247 Lloyd Noble Center
- 242 Parkview Apartments
- 404 Yorkshire Apartments
- 707 Oil Well Blowout School

### CLASSROOM BUILDINGS

- AH\* Adams Hall (50)
- ARM Armory (59)
- BL Bizzell Library (49)
- BL1\* Bizzell Library (49A)
- BURT\* Burton Hall (27)
- CARN\* Carnegie Building (30)
- CCDS Honors House (87)
- CEC\* Carson Engineering Center (6)
- CH\* Carpenter Hall (12)
- CHB Chemistry Building (19)
- CHBA Chemistry Building Annex (19A)
- CMC\* Catlett Music Center (15)
- COH\* Copeland Hall (70)
- COLM\* Commissary (78)
- CRAD Craddock Hall (14)
- CRSM\* Cross Main (124)
- CSKF Ceramic Kiln Facility (236)
- DAH\* Dale Hall (72)
- DAHT\* Dale Hall Tower (71)
- EL Ellsworth Collings Hall (68)
- EL Engineering Lab (22)
- FAC\* Fine Arts Center (9)
- FH\* Felgar Hall (13)
- FIH Field House (52)
- FJC\* Fred Jones Art Center (5)
- FL Fears Lab (226)
- FORM Forum OCCE (128)
- GH\* Gould Hall (69)
- GIH\* Gittinger Hall (61)
- GLCH\* George Lynn Cross Hall (62)
- HEST\* Hester Hall (56)
- HH Holmberg Hall (10)
- HHC\* Huston Huffman Physical Fitness Center (103)
- JFH\* Jacobson Faculty Hall (11)
- KH\* Kaufman Hall (67)
- LC\* Law Center (200)
- MH Monnet Hall (20)
- MUSE Observatory (93)
- NH\* Nielsen Hall (57)
- NML\* Noble Microscopy Lab (63B)
- N101 Airport Operations, North Campus (335)
- OBS\* Oklahoma Biological Survey (228)
- OFC Old Faculty Club (1)
- OMS Oklahoma Memorial Stadium (66)
- OMNH\* Sam Noble Oklahoma Museum of Natural History (205)
- PHSC\* Physical Sciences Center (18)
- POOL Murray Case Sells Swim Complex (137)
- RH Richards Hall (58)
- RHA Richards Hall Addition (58A)
- RHYN Rhyne Hall (53)
- SCI Science Hall (29)
- SEC\* Sarkeys Energy Center (8)
- SUT Sutton Hall (28)
- S6 Bldg. 6, South Campus (213)
- WHIT\* Whitehand Hall (3)

\*Buildings accessible to persons with disabilities

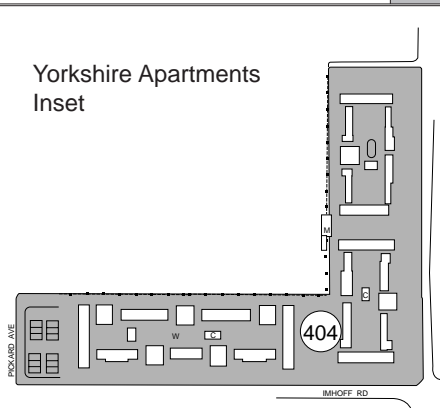
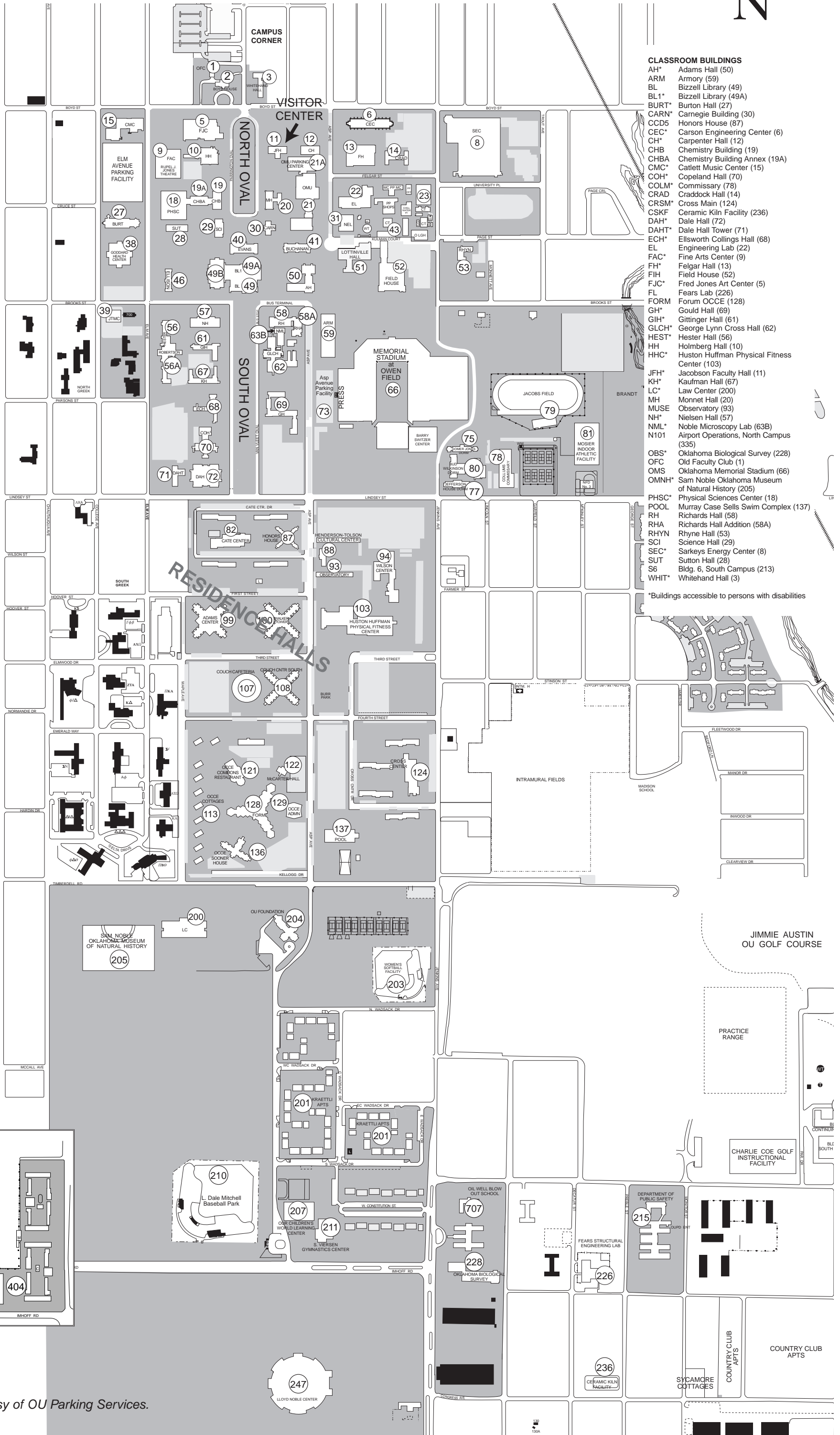

# CAMPUS INFORMATION DIRECTORY

QUESTIONS	OFFICE	LOCATION	TELEPHONE
ACT Test	Counseling & Testing Services	Goddard Health Center, Rm. 201	325-2911
Address Changes	Registration Office	Buchanan Hall, Rm. 230	325-3572
Add/Drop	Registration Office	Buchanan Hall, Rm. 230	325-3572
Admissions	Admissions Office	Buchanan Hall, Rm. 127	325-2252
Advance Standing Exams	Admissions Office	Buchanan Hall, Rm. 127	325-2252
Advising	College Office	See List Below	
African American Student Services	Center for Student Life	Student Union, 3rd Floor South	325-3163
American Indian Student Services	Center for Student Life	Student Union, 3rd Floor South	325-3163
Asian American Student Services	Center for Student Life	Student Union, 3rd Floor South	325-3163
Assessment	Assessment Center	Carnegie Bldg., 2nd Floor	325-1684
Audit Forms	Registration Office	Buchanan Hall, Rm. 230	325-3572
Books and Supplies	Bookstore	Asp Avenue Parking Facility	325-3511
Cancellation of Enrollment	Registration Office	Buchanan Hall, Rm. 230	325-3572
Catalogs	Bookstore	Asp Avenue Parking Facility	325-3511
Child Care Center	Our Children's World Learning Center	501 Wadsack St.	325-0528
Class Schedule	Online	<a href="http://www.ou.edu/admrec/registration.html">http://www.ou.edu/admrec/registration.html</a>	
CLEP Examination	Independent Study	1600 S. Jenkins	325-4414
Commuter Student Information	Commuter Student Assoc.	Conoco Student Leadership Wing	325-1031
Continuing Education	College of Continuing Education	OCCE Admin., Rm. B-4	325-1021
Counseling (Personal)	Counseling & Testing Services	Goddard Health Center, Rm. 201	325-2911
Disabled Student Services	Office of Disability Services	Goddard Health Center, Rm. 166	325-3852
			or TDD 325-4173
Employment	Personnel Services	Nuclear Engr. Lab., Rm. 205	325-1826
Enrollment	Online/Registration Office	<a href="http://enroll.ou.edu/BuchananHall">enroll.ou.edu/Buchanan Hall</a> , Rm. 230	325-3572
Evening Student Services	Center for Student Life	Student Union, Rm. 206	325-4028
Fees (payment of University Bills)	Bursar	Buchanan Hall, Rm. 105	325-3122
Financial Aid	Financial Aid Office	Buchanan Hall, Rm. 216	325-4521
Grades (Semester)	Records Office	Buchanan Hall, Rm. 330	325-4147
Graduation	College Office	See List Below	
(a) Application	College Office		
(b) Cap and Gown	Bookstore	Buchanan Hall, Rm. 330	325-4147
(c) Diplomas	Records Office	Asp Avenue Parking Facility	325-3511
(d) Invitations	Bookstore	Asp Avenue Parking Facility	325-3511
(e) Rings	Bookstore	Asp Avenue Parking Facility	325-3511
Health Insurance (Student)	Insurance Office	Nuclear Engineering Lab	325-9196
Hispanic/Latin Student Services	Center for Student Life	Student Union, 3rd Floor South	325-3163
Housing Programs	Campus Services	Walker Tower, Rm. 126	325-2511
ID Cards	OneCard Office	Student Union, Rm. 127	325-3113
Independent Study (Correspondence)	Independent Study	OCCE Admin., Rm. B-1	325-1921
International Student Information	International Student Services	Old Science Hall, Rm. 103	325-3337
Internships	Career Services	Student Union, Rm. 323	325-1974
Intersession	Intersession Office	OCCE Admin., Rm. 202	325-2899
Intramural & Recreational Sports	Recreational Services	Huston Huffman Center, Rm. 149	325-3053
Jobs on Campus	Employment and Compensation	NEL, Rm. 205	325-1826
Library Books	Bizzell Library	Bizzell Library	325-3341
Loans, Scholarships, Grants	Financial Aid Services	Buchanan Hall, Rm. 216	325-4521
(a) Disbursement	Bursar's Office	Buchanan Hall, Rm. 105	325-3123
Medical Services	Goddard Health Center	Goddard Health Center	325-4441
Name Changes	Records Office	Buchanan Hall, Rm. 330	325-4147
Prospective Student Information	Prospective Student Services	Jacobson Hall, Rm. L1	325-2151
Parking Permits	Parking & Transit	Robertson Hall, Rm. 311	325-3311
Parking Tickets	Parking & Transit	Robertson Hall, Rm. 311	325-3311
Placement Tests	Assessment & Learning Center	Carnegie Bldg., Rm. 200	325-4336
Reading Clinic	College of Education	Education Bldg., Rm. 127	325-4844
Readmission	Admissions Office	Buchanan Hall, Rm. 127	325-2252
Records (Academic)	Records Office	Buchanan Hall, Rm. 330	325-4147
Residency	Admissions Office	Buchanan Hall, Rm. 127	325-2252
Sports Information	Athletic Department	Oklahoma Memorial Stadium	325-8231
Tickets (Athletic)	Athletic Ticket Office	Stadium, Gate 15	325-6511
Tickets (Fine Arts)	Fine Arts Ticket Service	Fine Arts Center, Rm. 123	325-4101
TOEFL	Counseling & Testing Services	Goddard Health Center, Rm. 201	325-2911
Transcripts of Student Records	Records Office	Buchanan Hall, Rm. 330	325-4147
Transfer Student Information	Prospective Student Services	Jacobson Hall, Rm. L1	325-2151
Verification of Enrollment	Records Office	Buchanan Hall, Rm. 330	325-4147
Veterans Affairs	Veterans Office	Buchanan Hall, Rm. 231	325-4308
Veterans Student Services	Office of Veteran Services	Goddard Health Center, Rm. 166	325-3852
Withdrawal from University (all Classes)	College Office	See List Below	

## COLLEGE OFFICE LOCATION

OFFICE	LOCATION	TELEPHONE
Architecture	Gould Hall, Rm. 162	(405) 325-2444
Arts and Sciences	Ellison Hall, Rm. 124	(405) 325-4411
Business Administration	Adams Hall, Rm. 105	(405) 325-6021
Continuing Education	OCCE Admin., Rm. 111	(405) 325-4414
Education	Ellsworth Collings Hall, Rm. 114	(405) 325-1081
Engineering	Felgar Hall, Rm. 112	(405) 325-4096
Fine Arts	Fred Jones Jr. Memorial Art Center, Rm. 122	(405) 325-7370
Geosciences	Energy Center Tower, Rm. 710	(405) 325-3101
Graduate	Buchanan Hall, Rm. 313	(405) 325-3811
Journalism	Copeland Hall, Rm. 101	(405) 325-2721
Liberal Studies	OCCE Admin., Rm. 226	(405) 325-1061
Law	Law Center, Rm. 200	(405) 325-4699
University College	Carnegie Bldg., Rm. 100	(405) 325-3521
Special Students		
(a) With Degrees	Buchanan Hall, Rm. 313	(405) 325-3811
(b) Without Degrees	Carnegie Bldg., Rm. 100	(405) 325-3521